

FILE NAME: \\users\kaj\p\Documents\17-156 1625 Military Trail Phase 10, CPT E, analysis.rvt



DECEMBER 21st - 6:18pm  
SCALE: 1 : 1500

20  
A6 00



DECEMBER 21st - 1:18pm  
SCALE: 1 : 1500

15  
A6 00



MARCH/SEPTEMBER 21st - 6:18pm  
SCALE: 1 : 1500

10  
A6 00



MARCH/SEPTEMBER 21st - 1:18pm  
SCALE: 1 : 1500

5  
A6 00



DECEMBER 21st - 5:18pm  
SCALE: 1 : 1500

19  
A6 00

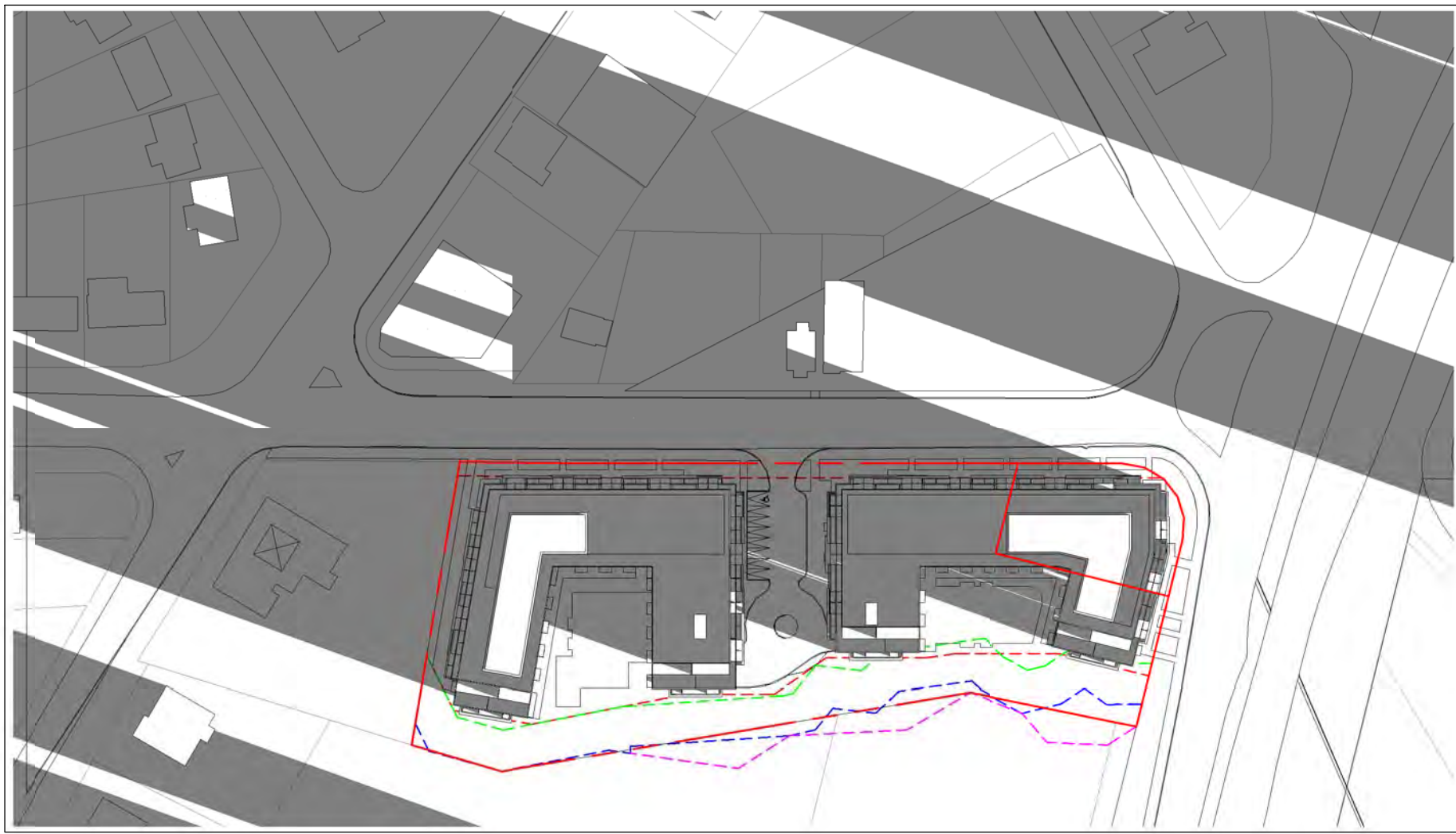

DECEMBER 21st - 12:18pm  
SCALE: 1 : 1500

14  
A6 00

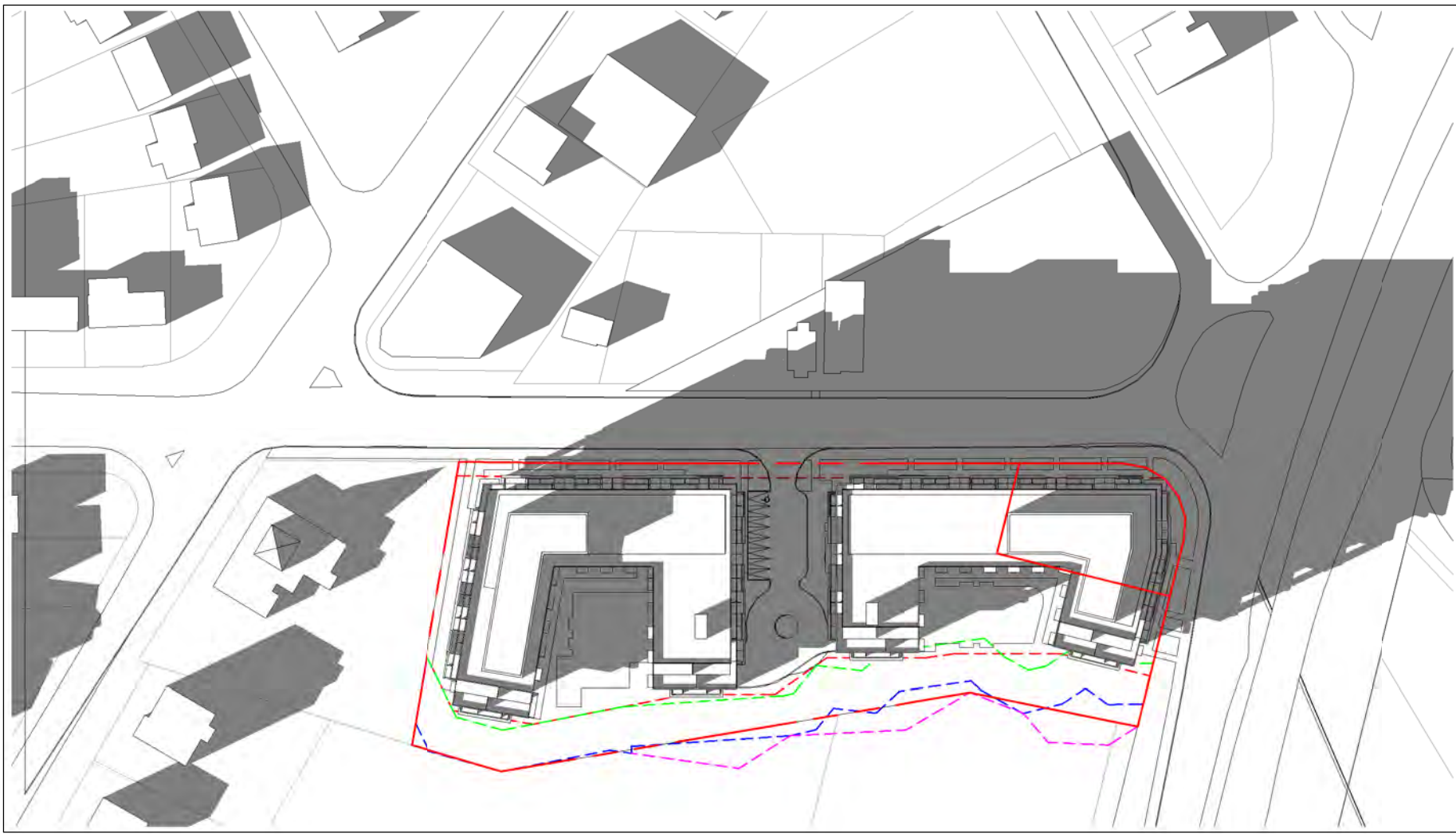

MARCH/SEPTEMBER 21st - 5:18pm  
SCALE: 1 : 1500

9  
A6 00



MARCH/SEPTEMBER 21st - 12:18pm  
SCALE: 1 : 1500

4  
A6 00

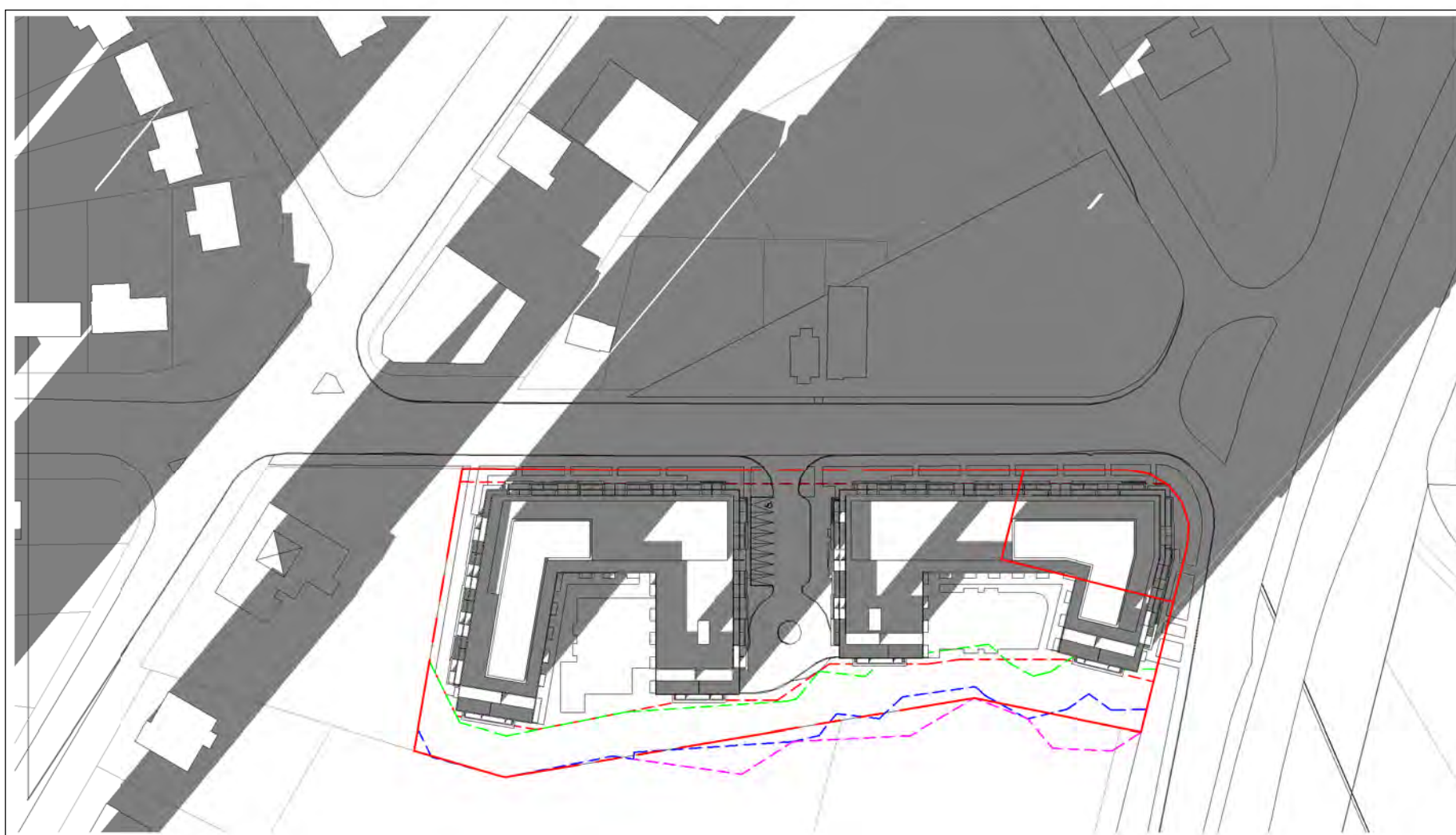

DECEMBER 21st - 4:18pm  
SCALE: 1 : 1500

18  
A6 00



DECEMBER 21st - 11:18am  
SCALE: 1 : 1500

13  
A6 00



MARCH/SEPTEMBER 21st - 4:18pm  
SCALE: 1 : 1500

8  
A6 00



MARCH/SEPTEMBER 21st - 11:18am  
SCALE: 1 : 1500

3  
A6 00

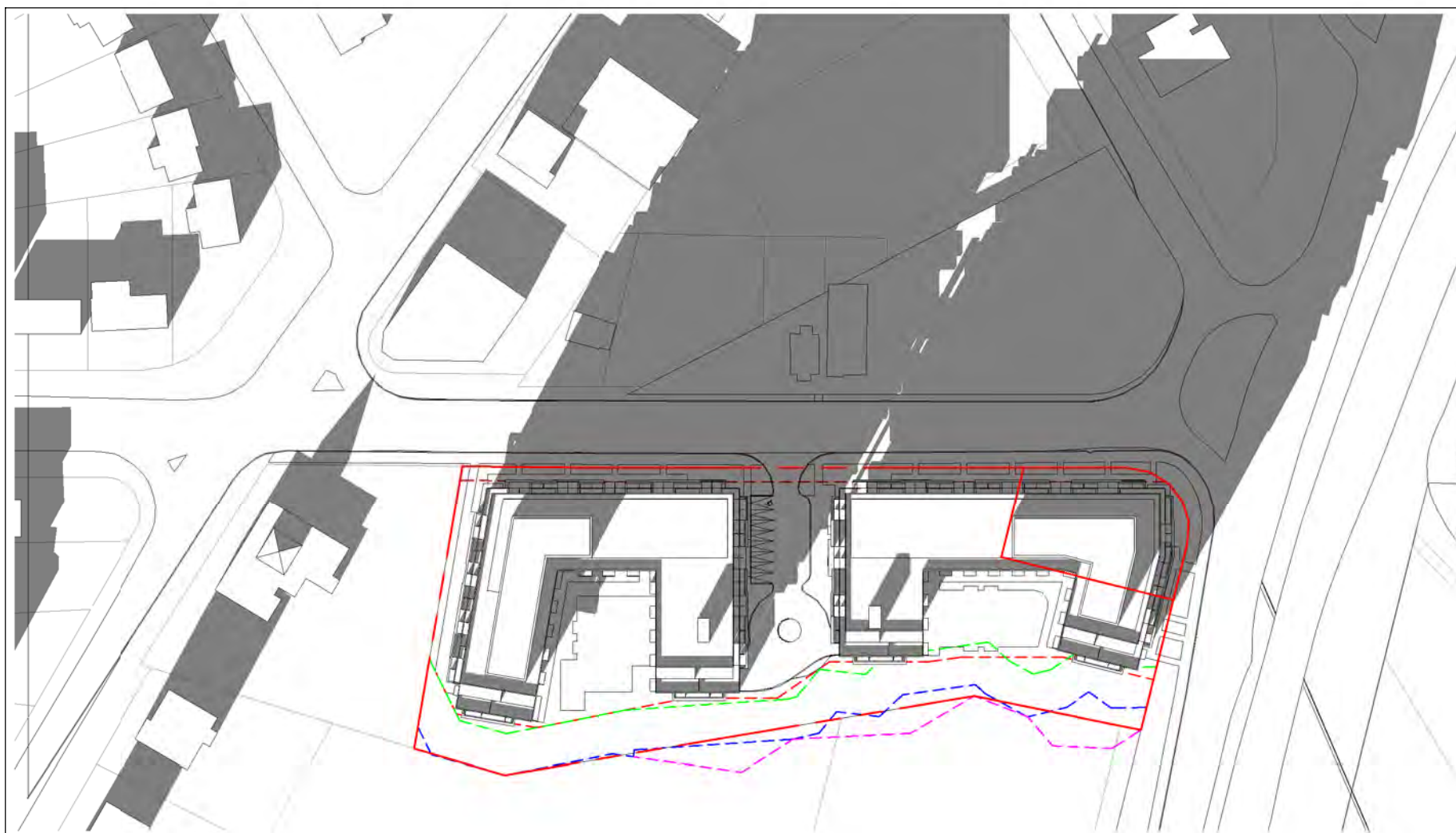

DECEMBER 21st - 3:18pm  
SCALE: 1 : 1500

17  
A6 00

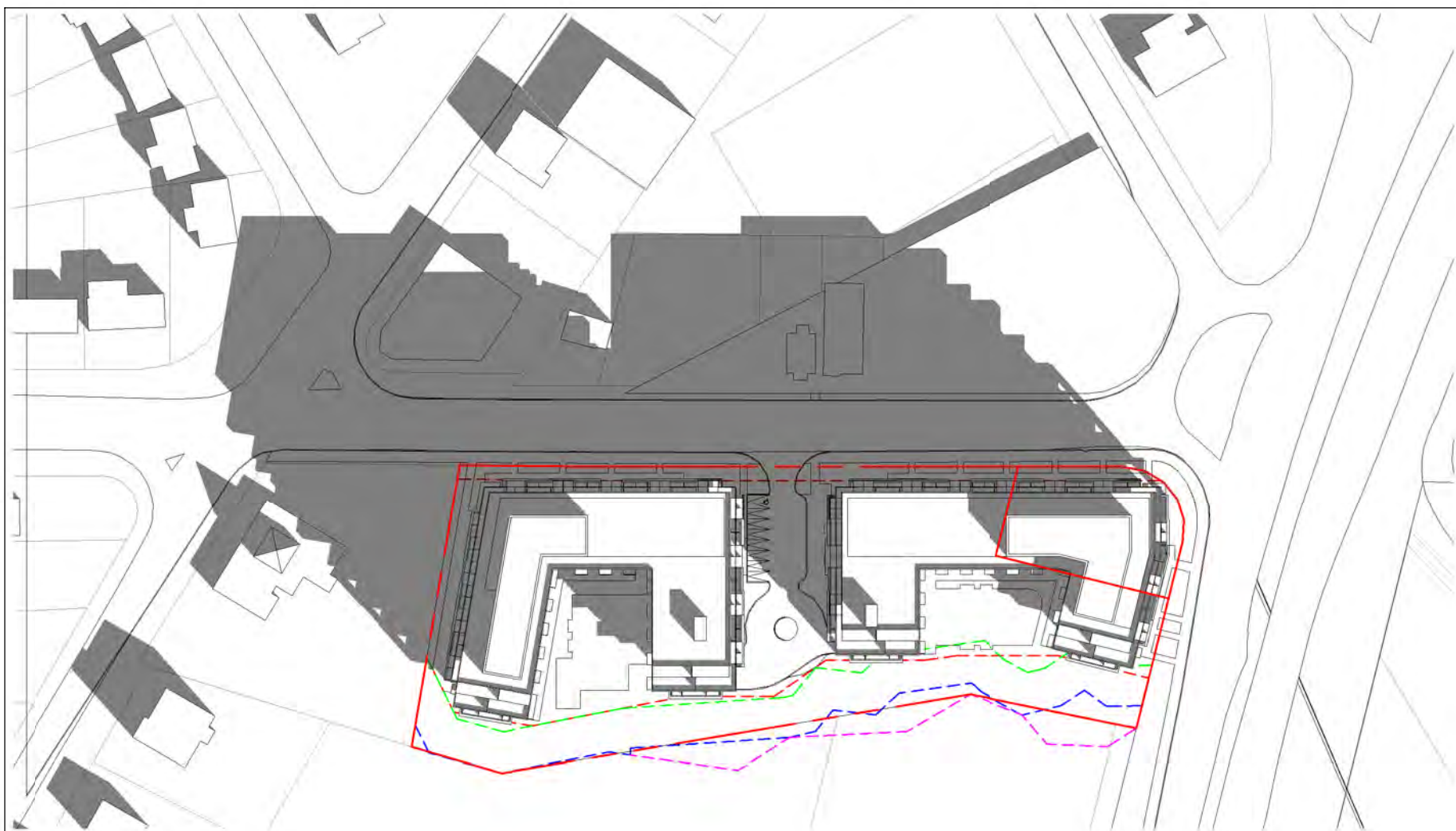

DECEMBER 21st - 10:18am  
SCALE: 1 : 1500

12  
A6 00



MARCH/SEPTEMBER 21st - 3:18pm  
SCALE: 1 : 1500

7  
A6 00



MARCH/SEPTEMBER 21st - 10:18am  
SCALE: 1 : 1500

2  
A6 00



DECEMBER 21st - 2:18pm  
SCALE: 1 : 1500

16  
A6 00

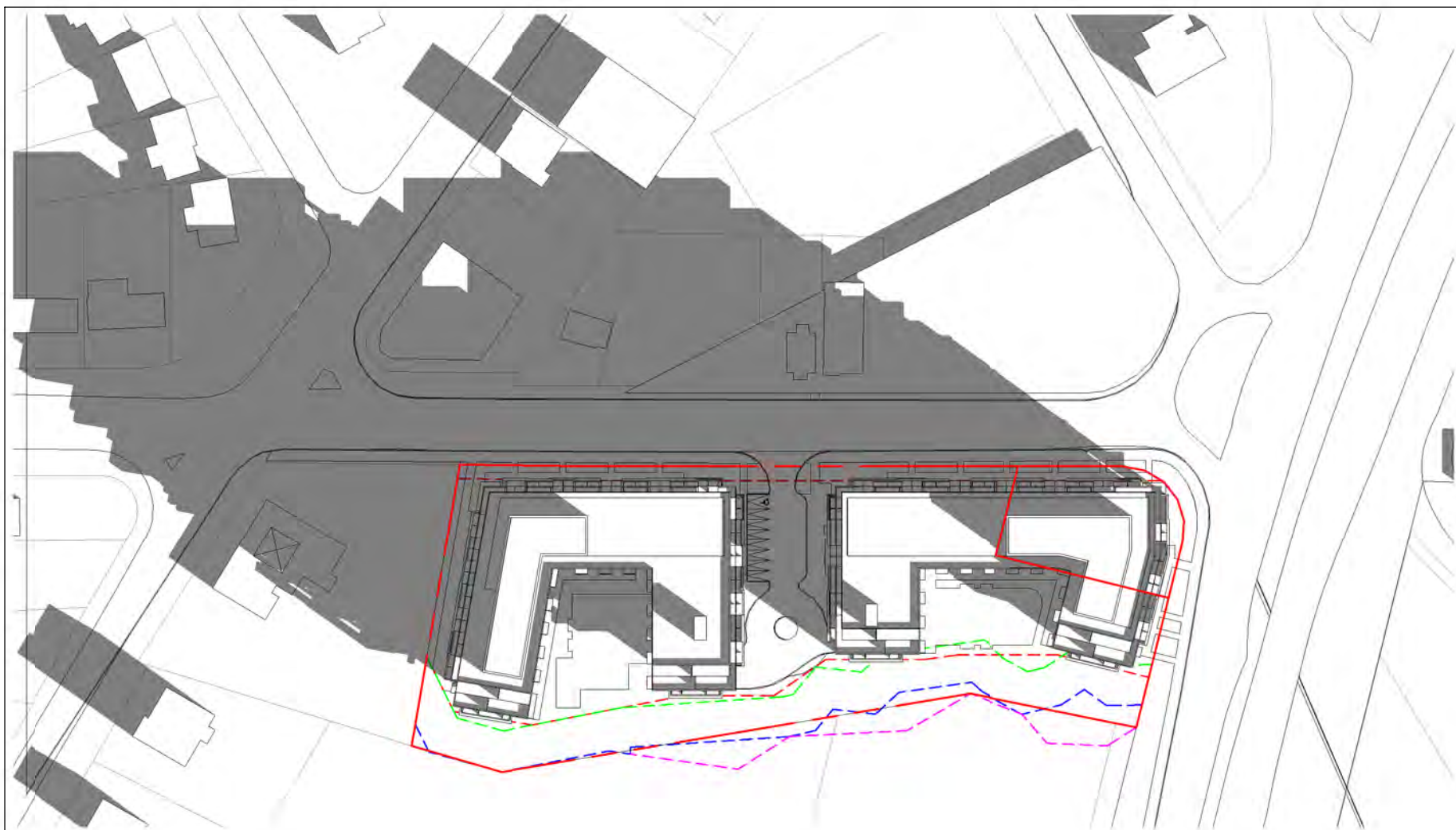

DECEMBER 21st - 9:18am  
SCALE: 1 : 1500

11  
A6 00



MARCH/SEPTEMBER 21st - 2:18pm  
SCALE: 1 : 1500

6  
A6 00



MARCH/SEPTEMBER 21st - 9:18am  
SCALE: 1 : 1500

1  
A6 00

# Kohn

Kohn Partnership Architects Inc.  
116 Spadina Avenue, Suite 501, Toronto ON M5V 2K6  
Tel 416.703.6700 www.kohnarchitects.com

ALL DIMENSIONS ARE GIVEN IN MILLIMETRES UNLESS OTHERWISE INDICATED.  
DO NOT SCALE DRAWINGS.  
CONTRACTOR SHALL VERIFY AND CHECK ALL DIMENSIONS AND CONDITIONS ON SITE PRIOR TO STARTING ANY OF THE WORK AND REPORT ANY DISCREPANCY TO THE ARCHITECT AND CORRECT THEM BEFORE PROCEEDING. CONSTRUCTION MUST CONFORM TO ALL APPLICABLE CODES AND REQUIREMENTS OF AUTHORITIES HAVING JURISDICTION PERTAINING TO THIS APPLICATION.  
THE ARCHITECT BEARS NO RESPONSIBILITY FOR THE INTERPRETATION OF THESE DOCUMENTS BY THE CONTRACTOR. UPON WRITTEN APPLICATION THE ARCHITECT WILL PROVIDE WRITTEN OR GRAPHIC CLARIFICATION AS SUPPLEMENTARY INFORMATION REGARDING THE INTENT OF THE CONTRACT DOCUMENTS.  
LOCATIONS OF EXPOSED MECHANICAL OR ELECTRICAL DEVICES, FITTINGS AND PIPES ARE INDICATED ON ARCHITECTURAL DRAWINGS WHICH SHALL GOVERN OVER THE MECHANICAL AND ELECTRICAL DRAWINGS. THOSE ITEMS NOT CLEARLY LOCATED TO BE LOCATED AS INDICATED BY THE ARCHITECT.  
NO INVESTIGATION HAS BEEN UNDERTAKEN OR REPORTED ON THIS OFFICE IS REQUESTED TO THE ENVIRONMENTAL CONDITIONS OR POLLUTIONS OF THIS SITE.  
COPYRIGHT 2005 KOHN ARCHITECTS INC.  
COPYRIGHT OF THIS DRAWING AND THE DESIGN INTENT IS RESERVED BY THE ARCHITECT. THE DRAWINGS AND ALL ASSOCIATED DOCUMENTS ARE AN INSTRUMENT OF SERVICE BY KOHN ARCHITECTS INC. THE DRAWINGS AND THE INFORMATION CONTAINED THEREIN MAY NOT BE REPRODUCED IN WHOLE OR IN PART WITHOUT THE WRITTEN PERMISSION OF THE KOHN ARCHITECTS INC.  
ALL DRAWINGS ARE THE PROPERTY OF THE ARCHITECT AND MUST BE RETURNED ON REQUEST.

## ISSUE DATES AND DISTRIBUTION LOG

No.	Date	Note
1	19/10/09	ZBA SUBMISSION



ALTREE



Project:  
**1625 MILITARY TRAIL**

HIGHLAND TRAIL LIMITED PARTNERSHIP

1625 MILITARY TRAIL & 6000 KINGSTON RD.

SCARBOROUGH ONTARIO

Drawing Title:  
**SHADOW STUDIES**

Drawn By: <b>LM/DV</b>	Checked By: <b>AN</b>	Project No. <b>17-156</b>
Date Plotted: <b>2019-10-09 2:38:55 PM</b>	Scale: <b>1 : 1500</b>	Drawing No.: <b>A6 00</b>

A6 00





JUNE 21st - 6:18pm  
SCALE: 1 : 1500  
10  
A6 01



JUNE 21st - 1:18pm  
SCALE: 1 : 1500  
5  
A6 01

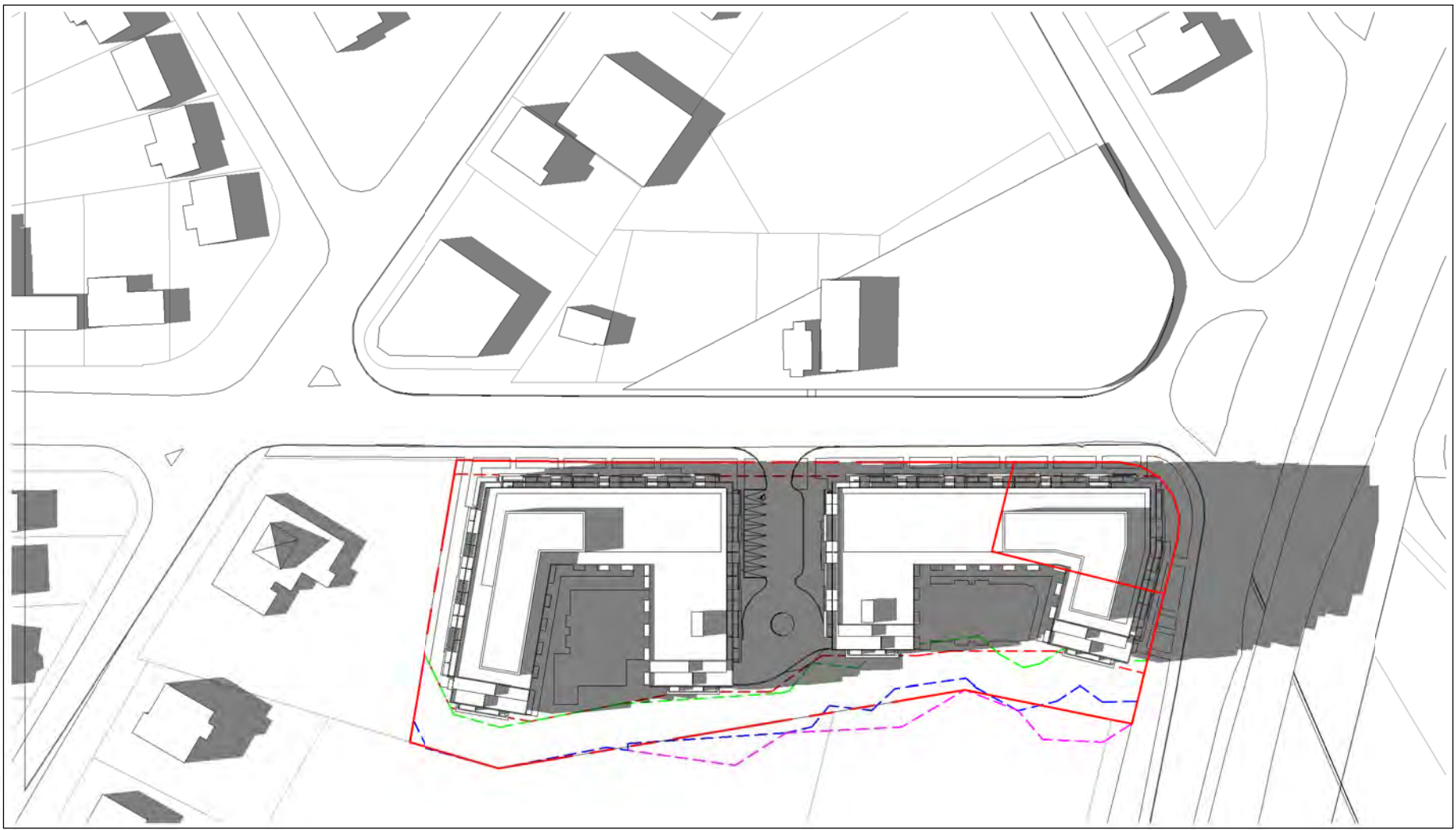

JUNE 21st - 5:18pm  
SCALE: 1 : 1500  
9  
A6 01



JUNE 21st - 12:18pm  
SCALE: 1 : 1500  
4  
A6 01

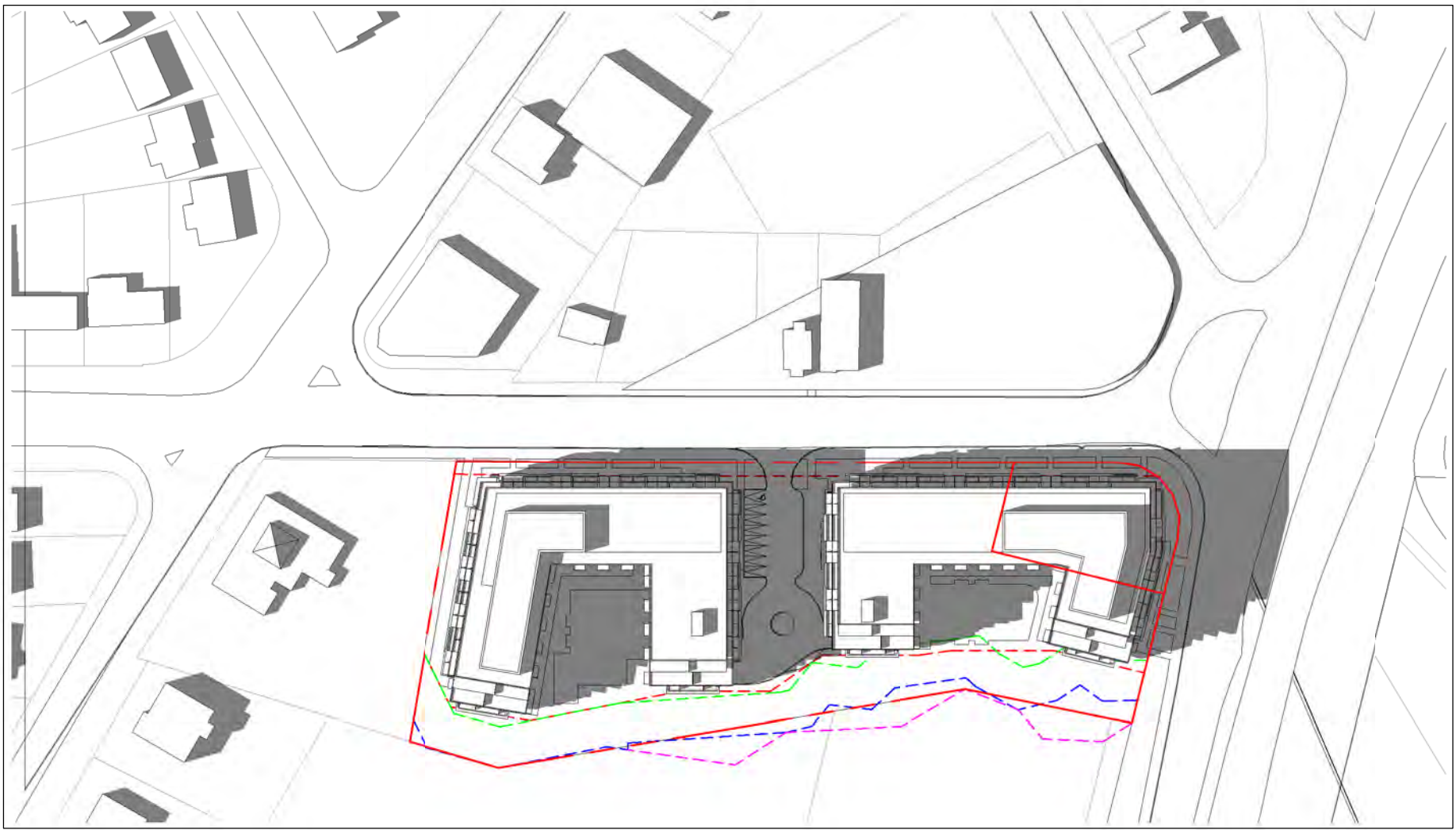

JUNE 21st - 4:18pm  
SCALE: 1 : 1500  
8  
A6 01



JUNE 21st - 11:18am  
SCALE: 1 : 1500  
3  
A6 01



JUNE 21st - 3:18pm  
SCALE: 1 : 1500  
7  
A6 01



JUNE 21st - 10:18am  
SCALE: 1 : 1500  
2  
A6 01



JUNE 21st - 2:18pm  
SCALE: 1 : 1500  
6  
A6 01



JUNE 21st - 9:18am  
SCALE: 1 : 1500  
1  
A6 01

# Kohn

Kohn Partnership Architects Inc.  
116 Spadina Avenue, Suite 501, Toronto ON M5V 2K6  
Tel 416.703.6700 www.kohnarchitects.com

ALL DIMENSIONS ARE GIVEN IN MILLIMETRES UNLESS OTHERWISE INDICATED.  
DO NOT SCALE DRAWINGS.  
CONTRACTOR SHALL VERIFY AND CHECK ALL DIMENSIONS AND CONDITIONS ON SITE PRIOR TO STARTING ANY OF THE WORK AND REPORT ANY DISCREPANCY TO THE ARCHITECT AND CONSULT WITH BEFORE PROCEEDING. CONSTRUCTION MUST CONFORM TO ALL APPLICABLE CODES AND REQUIREMENTS OF AUTHORITIES HAVING JURISDICTION PERTAINING TO THIS APPLICATION.  
THE ARCHITECT BEARS NO RESPONSIBILITY FOR THE INTERPRETATION OF THESE DOCUMENTS BY THE CONTRACTOR. UPON WRITTEN APPLICATION THE ARCHITECT WILL PROVIDE WRITTEN OR GRAPHIC CLARIFICATION AS SUPPLEMENTARY INFORMATION REGARDING THE INTENT OF THE CONTRACT DOCUMENTS.  
LOCATIONS OF EXPOSED MECHANICAL OR ELECTRICAL DEVICES, FITTINGS AND PARTS ARE INDICATED ON ARCHITECTURAL DRAWINGS. THESE SHALL COORDINATE WITH THE MECHANICAL AND ELECTRICAL DRAWINGS. THOSE ITEMS NOT CLEARLY LOCATED TO BE LOCATED AS DIRECTED BY THE ARCHITECT.  
NO INVESTIGATION HAS BEEN UNDERTAKEN OR REPORTED ON THIS OFFICE IS REQUIRED TO THE ENVIRONMENTAL CONDITIONS OR POLLUTIONS OF THIS SITE.  
COPYRIGHT 2005 KOHN ARCHITECTS INC.  
COPYRIGHT OF THIS DRAWING AND THE DESIGN INTENT IS RESERVED BY THE ARCHITECT. THE DRAWINGS AND ALL ASSOCIATED DOCUMENTS ARE AN INSTRUMENT OF SERVICE BY KOHN ARCHITECTS INC. THE DRAWINGS AND THE INFORMATION CONTAINED THEREIN MAY NOT BE REPRODUCED IN WHOLE OR IN PART WITHOUT PRIOR WRITTEN PERMISSION OF THE KOHN ARCHITECTS INC.  
ALL DRAWINGS ARE THE PROPERTY OF THE ARCHITECT AND MUST BE RETURNED ON REQUEST.

## ISSUE DATES AND DISTRIBUTION LOG

No.	Date	Note
1	19/10/09	ZBA SUBMISSION

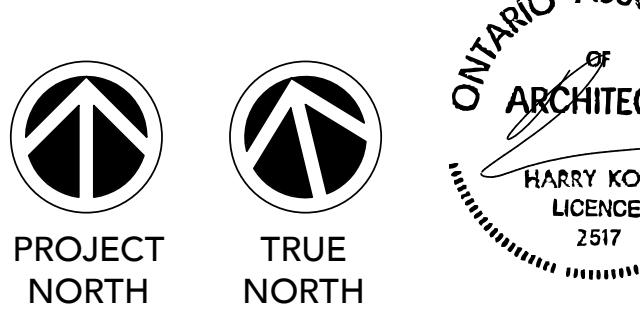

Project:  
**1625 MILITARY TRAIL**  
  
HIGHLAND TRAIL LIMITED PARTNERSHIP  
1625 MILITARY TRAIL & 6000 KINGSTON RD.  
SCARBOROUGH ONTARIO  
Drawing Title:  
**SHADOW STUDIES**

Drawn By: <b>LM/DV</b>	Checked By: <b>AN</b>	Project No. <b>17-156</b>
Date Plotted: <b>2019-10-09 2:39:34 PM</b>	Scale: <b>1 : 1500</b>	Drawing No.: <b>A6 01</b>